

# THE EBURY KITCHEN



Durability, longevity and practicality lie at the core of a Cue & Co kitchen making a solid frame for beauty and aesthetics. The process is complete from the initial concept fulfilling the client's requirements, through to the design, execution and completion. It is the sum of careful attention to detail and excellent craftsmanship that makes a Cue & Co kitchen unique and visionary.

The Ebury has been designed to look as paired down and as minimal as possible and the drawers sit on top of one another. Where it is mostly about straight lines, a small curve is introduced around the handle. It is a contemporary handleless design.



# THE EBURY KITCHEN

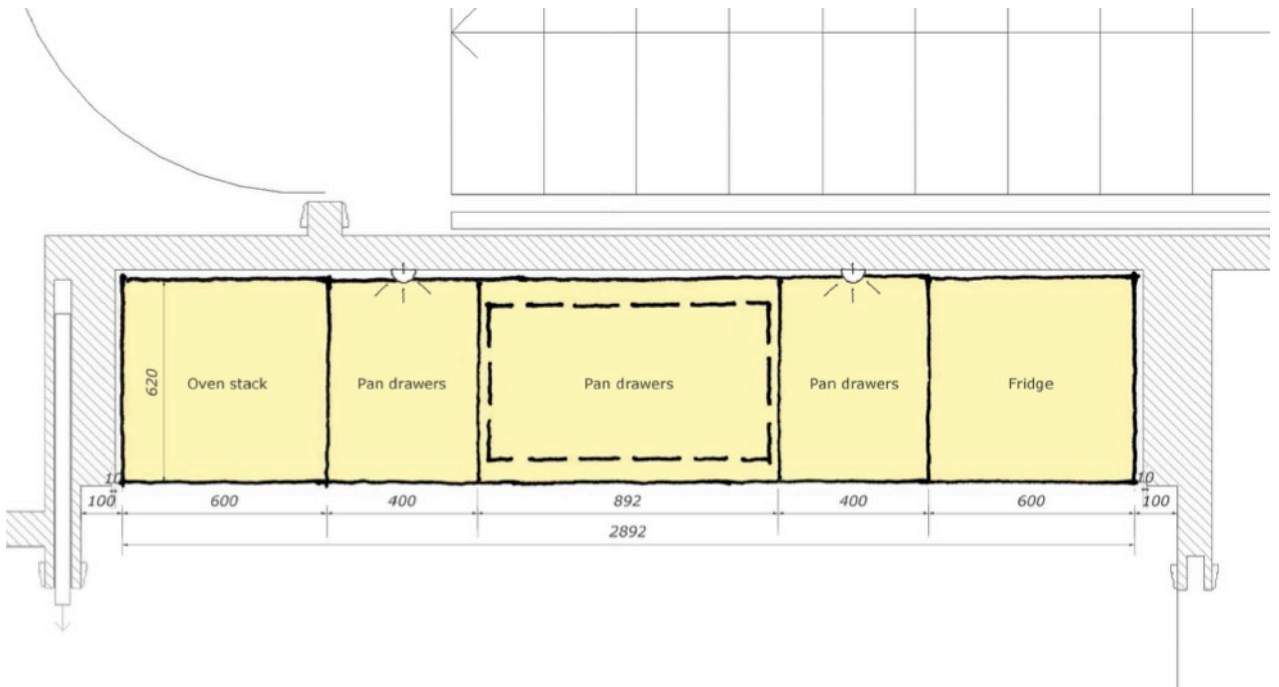

During the initial planning stage we prepare a 2D floor plan with a 3D perspective drawing before developing the plans further.



# DESIGN SERVICE

## **Initial Stage**

Our design team is here to help you realize your ideal kitchen. The initial meeting with one of our designers should be booked approximately one to two weeks in advance with our office. This first meeting in our showroom is free of charge. Please call: 020 7731 4728.

## **What to Bring**

The more information that is brought to this initial meeting will help provide the designer with a comprehensive sense of what you wish to achieve. This includes scaled architectural plans, ceiling heights, any relevant photographs of the space, a short brief on you and your lifestyle and any mood images that can help the designer identify the style you are after.

## **What to Expect**

During the first design consultation, the designer will discuss the project in detail with you covering everything from layout, to materials, finishes and colours, through to appliances and brassware. All this important information is taken down and considered in order to produce the plans.

## **Plans**

Approximately 10-15 working days after the initial appointment, you will receive a pack. This includes a covering letter pointing out any important considerations, mood board images of the kitchen range you have based your design on, a 2D sketch floor plan, one 3D perspective drawing of a section of your drawing and a quotation.

## **Design Development**

At this stage if you wish to take the design further we charge an hourly rate of £65 (ex VAT) per hour to develop your drawings to include changes, additions and revisions.

## **Build and Install**

Once the drawings have been finalized and signed off a 50% deposit of the total cost will be required. Accurate joinery drawings are then drawn up for the workshop and the fabrication process begins. You should allow between 8-10 weeks for the kitchen to be completed before our installation team arrive on site to build your kitchen.



Unit 6, Parsons Green Depot, 33-39 Parsons Green Lane, London, SW6 4HH

[www.cueandco.com](http://www.cueandco.com)

T: +44 (0) 207 731 4728